

IP44 连接器 尺寸图

型号：ST510 (16A 3P)

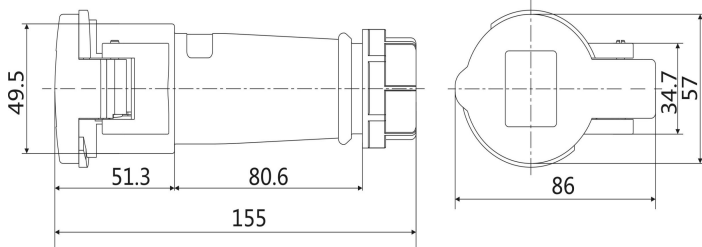

型号：ST514 (16A 4P)

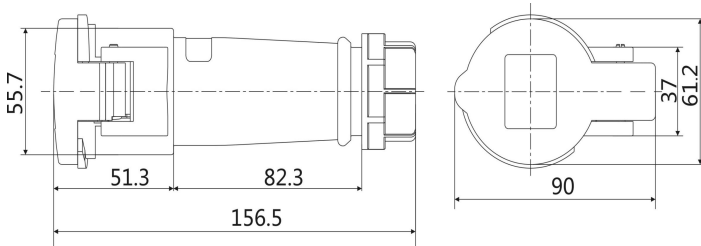

型号：ST5 (16A 5P)

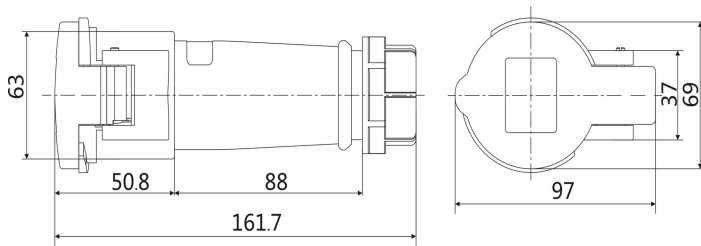

型号：ST522 (32A 3P)

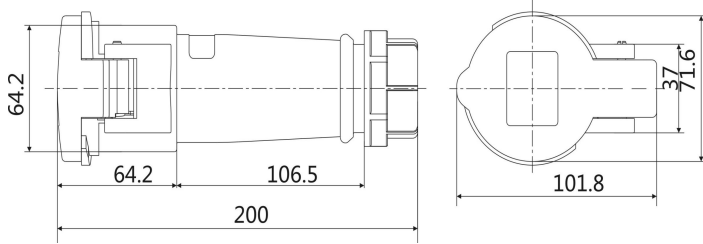

型号：ST526 (32A 4P)

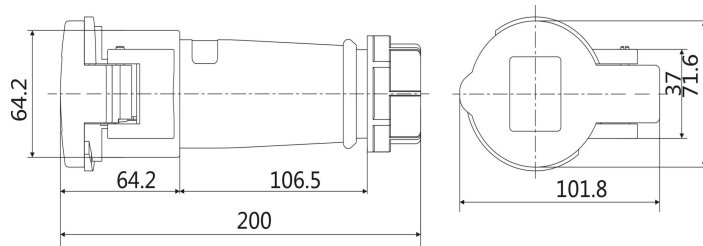

型号：ST6 (32A 5P)

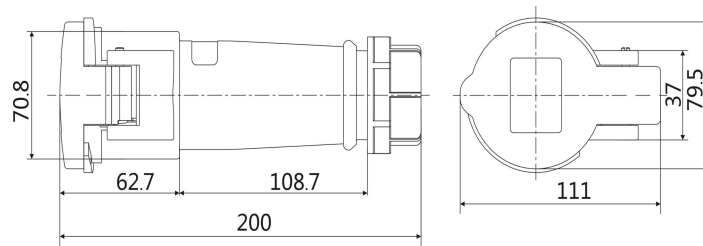

型号：ST1237（63A 3P）

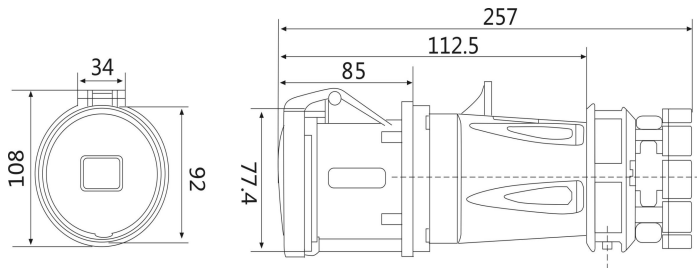

型号：ST1241（63A 4P）

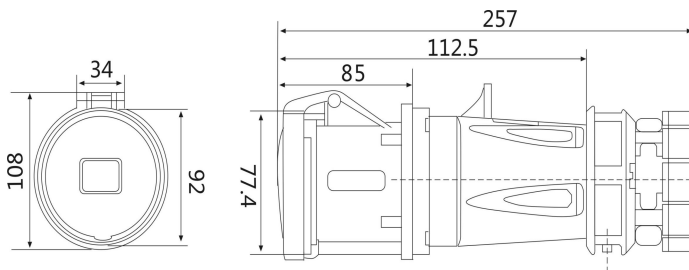

型号：ST1245（63A 5P）

